



**METROWEST
COMMERCIAL R.E.**

**FOR LEASE – GOLDEN TRIANGLE LOCATION !
RT. 9 RETAIL / MEDICAL / OFFICE
271 WORCESTER RD., FRAMINGHAM, MA**



PREMIER RT. 9 LOCATION WITH EASY ACCESS TO MASS PIKE !

Located just East of Rt. 126 and close to Shopper's World, Natick Mall, Venture West Plaza, Sherwood Plaza and many national retailers.

RT. 9 signage available, 79 parking spaces (front, side & rear of building) and easy access from all directions.

Co-tenants are: Sichuan Gourmet Restaurant – voted #1 in Metrowest and a huge foot traffic generator ! Formosa Asian Market & a residential r.e. office that will be leaving.

Traffic Count: 53,600 car per day – 1.8 acre lot

1ST FLOOR AVAILABLE:

Shown above 3,000 s.f.	ASKING \$25/s.f. NNN
Middle Unit 2,000 s.f.	AVAILABLE NOW ASKING - \$22/s.f. NNN
End unit 1,000 s.f.	ASKING \$30/s.f. NNN

(NNN = approx. \$7.50-\$8./s.f.)

Please call MARLENE ARON 508-740-0000 to view this property
ma@metrowestcre.com

The above information is from sources deemed reliable but cannot be guaranteed to be completely accurate. Prospective Lessees are advised to verify information. MetroWest Commercial RE represents the Lessor. MetroWest Commercial RE does not co-broke with Principals nor recognize representation after the first showing. Info date 10/11/2020

271 WORCESTER ROAD
FRAMINGHAM, MA

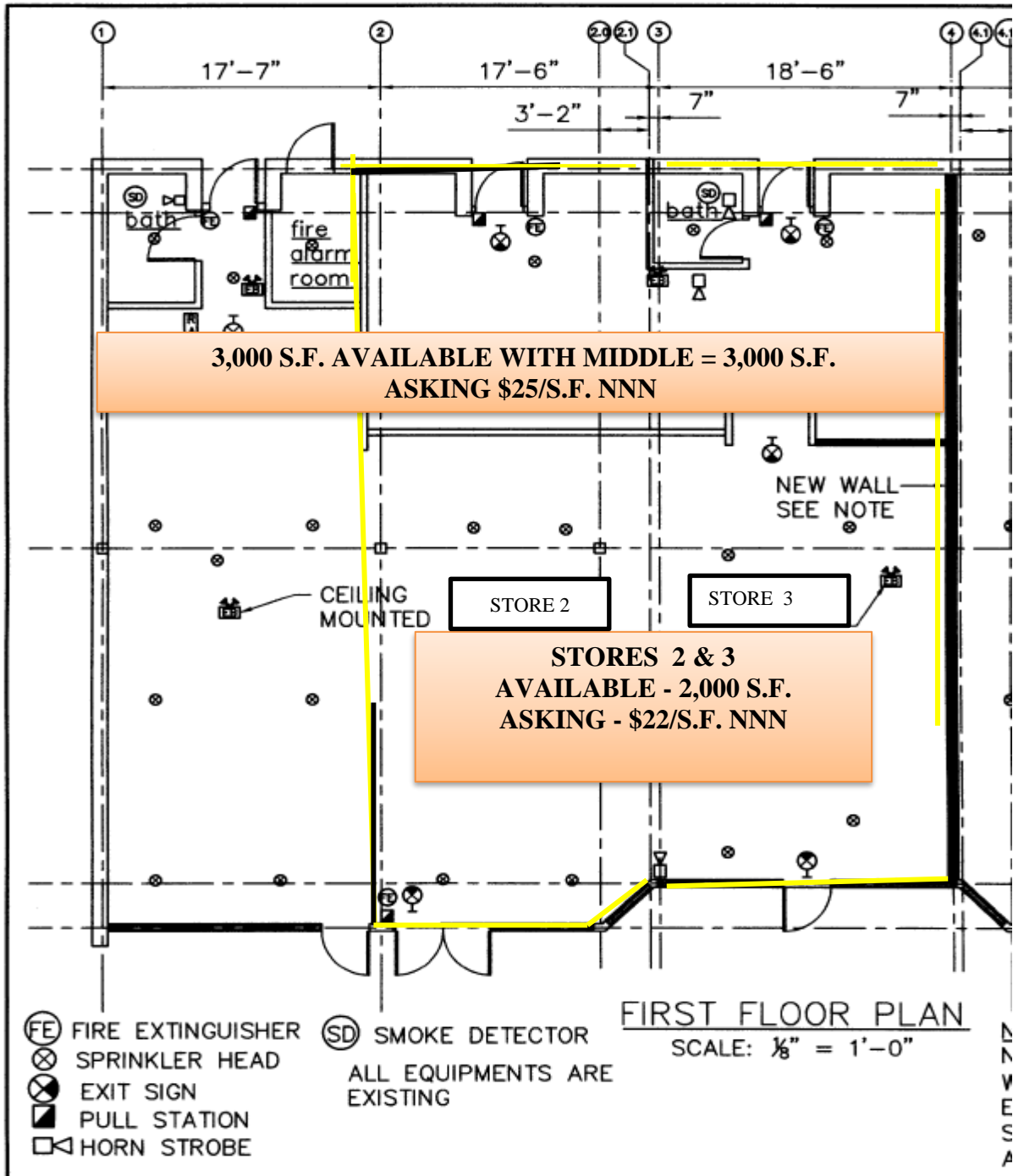

*SHOWN ABOVE - 2,000 or 3,000 S.F.
ROUTE 9 FACING SIDE – DIMENSION IS 50' DEEP.
(the above noted dimensions are interior dimensions)*

Please call MARLENE ARON 508-740-0000 to view this property

www.metrowestcre.com

*The above information is from sources deemed reliable but cannot be guaranteed to be completely accurate.
Prospective Lessees are advised to verify information. MetroWest Commercial RE represents the Lessor.*